

KITCHEN MAKEOVER 3

# 'THIS LAYOUT SUITS EVERYONE'S NEEDS'

*Knocking four rooms into one gave Clare and Rick Elliott more light and space to cook, eat, work and relax in*



**STYLING TIP**

*Give traditional units an update with contemporary light fittings, splashes of colour on walls, tiles or a splashback, and on-trend furniture and gadgets*

*Kitchens & bathrooms Versatile solution*

**F**or years, Clare Elliott cooked in a narrow galley kitchen lit only by a small window set high up in the wall. 'It was dark as the window faced east and the light was partly blocked by the garden wall,' says Clare. 'Last year we decided to have a big makeover.'

Architect Federica Vasetti recommended Clare and husband Rick knock through all four existing rooms – the kitchen, dining room, utility and conservatory – leaving just the living room at the front of the house untouched. 'There was so much dust that we basically decamped to this room,' says Clare.

Federica suggested that the Elliotts extend the back of their house by 1.75m and reconfigure the existing layout – for example, the kitchen is where the utility once was and this is now a separate room.

To maximise light in the new open-plan room, Federica designed a pitched roof above the kitchen with three Velux roof lights, and added two more roof

**← MODERN LOOK**

Clare has created a soothing space using neutral creams and greys, and even the splashes of aqua blue are calming

**↓ CLEVER DESIGN**

The kitchen is still galley in style, but it feels bigger without any wall units. The pitched roof brings in much-needed light



**KITCHEN DETAILS**

**HOMEOWNERS**

Clare Elliott, an accountant, and husband Rick, an IT specialist

**AGES** 47 and 48

**FAMILY** Rosie, 13, and Lizzie, 11

**LOCATION** Bristol

**PROPERTY**

Four-bedroom semi-detached house built in 1890

**COST OF NEW KITCHEN**

<b>Cabinetry</b>	£5,194
<b>Worktops &amp; splashback</b>	£3,226
<b>Appliances</b>	£3,730
<b>Flooring</b>	£3,250
<b>Sink &amp; taps</b>	£525
<b>Lighting</b>	£349.10
<b>Wallpaper</b>	£220

**TOTAL £16,494.10**

**→ VIEW THE FLOORPLAN**

An island unit separates the kitchen from the dining area, which leads out to outdoor decking. A separate utility space comes off the kitchen, and an open-plan living room and office is next to the kitchen-diner

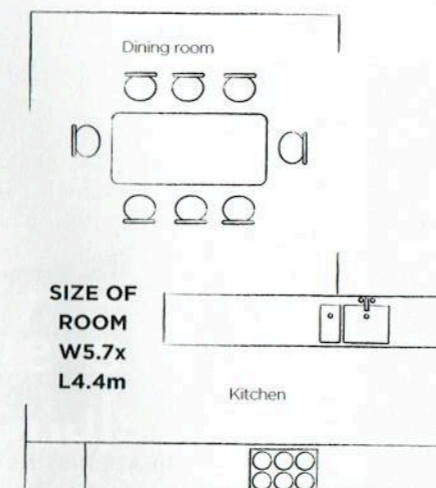

**WORK CARRIED OUT**

The kitchen, dining area, conservatory and utility room were knocked into one large open-plan space. The back wall was also extended into the garden by 1.75m to create even more space



*'We've laid oak flooring to create continuity'*

lights above the dining area. She also included bi-fold doors leading out to the large decking area.

It took the builders around 14 weeks to demolish and rebuild. 'Each room had different flooring, so all this had to be taken up,' says Clare. 'We've laid engineered oak flooring throughout, creating a seamless feel.'

Clare had already received quotes for the kitchen, but on Federica's recommendation she consulted a fitter, Steve Clothier, who was not only able to supply cheaper units, but also in a much better design. 'He incorporated a built-in microwave and large American-style fridge-freezer into the scheme,' says Clare.

The builders retrieved attractive blue Victorian tiles from the original 1880s fireplace, which inspired Clare to decorate in soft tones of blue and aqua.

Clare is delighted with the end result. 'We're so pleased with everything, our only change would be a quieter extractor fan,' she says. 'And I couldn't recommend our builder Neil Bridle more highly – he and his team arrived promptly and worked really hard.'

**↑ BOLD PATTERN**

Striking patterned wallpaper forms a contemporary background against the traditional Tuscany table and chairs

STOCKISTS  
Turn to  
page 181

## SHOPPING LIST

**CABINETS** Tortworth vanilla units, £5,194, Stephen Clothier at SC Kitchens  
**SINK & TAPS** Caple NEV150U under-mounted ceramic sink, £285; Franke Olympus swan-necked tap, £240, Nailsea Electrical  
**WORKTOP, SPLASHBACK & FLOORING** Aqua splashback, £700, Opus Glass Design. Ivory Fantasy pale granite worktops, £245 per sqm, Avon Marble Co. Engineered oak floorboards, £23 per sqm, SH Flooring  
**APPLIANCES** Caple ZC920 wine cooler, £345; Smeg TR93P Cavity dual-fuel range cooker, £1,690 Nailsea Electricals. Samsung American fridge-freezer, £940; Caple CM112 microwave, £160; Smeg DI112 dishwasher, £300; Caple ZC920 cookerhood, £295, all Nailsea Electrical Ltd  
**FURNITURE & ACCESSORIES** Blue bar stools, £149 each, John Lewis. Tuscany table and chairs, £1,900, Living Home Furnishings  
**LIGHTING** Nordlux Ripasso glass pendants, £59.70 each, The Lighting Company. Dar TON862 white pendants, £85 each, Ocean Lighting  
**WALLPAPER** Pintura Orvieto wallpaper by Romo, £55 per 10m roll (W52cm), Wallpaperdirect

## IDEAS TO STEAL

*Follow Clare's style tips to make the most of your room*



**↑ USE YOUR INTERNAL UNITS**  
Keep workspaces clear of clutter by introducing a pull-out larder or drawers to house essential items



**↑ BE CONFIDENT WITH COLOUR**  
Break up a neutral kitchen scheme with bright details such as a bold glass splashback



**↑ CREATE DISTINCT ZONES**  
Use low-level pendant lights to separate the kitchen and dining rooms in a large open-plan space