

REAL-LIFE HOMES WITH IDEAS TO STEAL LOFT / NEW BUILD / COTTAGE / VICTORIAN

House Beautiful

MAY 2020

MODERN LIVING / AFFORDABLE STYLE

BRIGHT IDEAS

Hot new style and decor trends

Amazing makeovers on a budget

Smart space-saving solutions

15
brilliant pages of
OUTDOOR
LIVING

GET OUT IN THE GARDEN!

Our pick of the best garden furniture
New trends from
RHS Chelsea
show winners

FIND YOUR

happy place

Create a sunlit haven at home

+ CREATE A SHELFIE

It's the new mood booster!

H
HEARST

9 770955 353377

05

£4.75

WHAT IT COST

Units	£14,000
Corian worktops	£3,000
Sink and tap	£2,639
Appliances	£2,482
Furniture	£2,886
Flooring	£2,062
Lighting	£370

TOTAL £27,439

'WE WANTED A SOCIABLE SPACE FOR ENTERTAINING'

Enlarging a tiny kitchen has resulted in the creation of a relaxed dining area, where one couple can enjoy spending time with friends

WORKTOP

Eyecatching Imperial Yellow Corian ensures the island has become the focal point of the kitchen. It forms an overhang, creating a breakfast bar

WINDOW SEAT
The built-in design is perfect for relaxing with a coffee and couples as seating for the dining table



Simon Baker, a theatre sound designer, and his wife Emma, a theatre director, live in a three-storey, four-bedroom, Victorian end-of-terrace in Bristol. They wanted to create a large, sociable cooking and eating space

Describe the old kitchen to us...

It was an L-shaped galley kitchen. Most of it projected into the garden by 2.4 metres in a single-storey extension – it was so small that you could just about fit in a two-seater table. The working area of the kitchen was set further back in the house. It looked as if different eras of Ikea cabinetry had been installed

and then undergone a lot of wear and tear, which isn't unusual for a busy family home but they needed it all replacing.

What was the main problem?

Lack of space – wherever we were, there just wasn't enough room. The rest of the ground floor was one big open area comprising a sitting room and a dining room that had been knocked together.

How did you plan to solve this issue?

Our first step was to employ architect Federica Vasetti of DHVA for advice. When we'd first arrived in Bristol we'd bought her old house. We'd loved it straight away, as she'd reconfigured its interior and created so much extra space in the process. We felt confident that she would design a better layout for us. She advised us on how to rework the ground floor and add a tiny kitchen extension. Planning permission was granted within eight weeks and then the building work began. You wasted no time getting started...

No. First, our builder Neil Bridge and his team demolished the ►

IN DETAIL THE BASICS

UNITS AND WORKTOPS

For similar units, try City Style in gloss Platinum, made to measure, £14,000; Corian worktops in Imperial Yellow and White, £3,000; all John Lewis & Partners

SINK AND TAP

Franke sink, £1,300; Franke Minerva three-in-one boiling water tap, £1,139; Toughened glass splashback in black, £115; all John Lewis & Partners

APPLIANCES

JLBIOS633 single pyrolytic multifunction oven, £499; AEG FSB41600Z integrated dishwasher, £486; AEG HG644351SM integrated gas hob, £229; Siemens freestanding fridge freezer, £699; Bosch built-in microwave, £319; all John Lewis & Partners. Acova column radiator, £250, Screwfix

FURNITURE

For similar bar stools, try Hay About a Stool, £199 each; for similar table, try Ercol Shalstone oval oak extending table, £899; for similar chairs, try Clio, £89 each; all John Lewis & Partners. Sideboard, £600, Afid Design. Stockholm cupboard, £315; magic shelf, £10; yellow steps, £15; all Ikea

FLOORING & WALLS

Marmoleum flooring, £75/sq m (including fitting), Natural Born. Rust-Oleum Chalk Board paint in black, £13/750ml, Homebase. Mid Lead Colour absolute matt emulsion, £47/2.5L, Little Greene

LIGHTING

Bobby floor light, £65, Habitat. Circus lights (above wall units), £60, Toast. Tom Raffield Skipper pendant in oak, £245, John Lewis & Partners

ACCESSORIES

Window seat cushions, from £9.99 each, TK Maxx. Saucepan, £60; casserole, £113; both Orla Kiely. Big jug (on table), £25, Habitat. Lavazza coffee machine, £149; Simplicity toaster £40; both John Lewis & Partners

GARDEN FURNITURE

Salsa garden chairs, £49 each; for similar table, try Henley by Kettler, £449; both John Lewis & Partners

FOR STORE DETAILS SEE
WHERE TO BUY PAGE

BLACK WALL
Covered in a chalkboard paint it works as a useful and quirky message board

MAKING PLANS

Despite being relatively small, the new extension has given the Bakers a good-size dining area with a bench seat in a newly created bay overlooking the courtyard garden. Bifold windows add to the feeling of space.

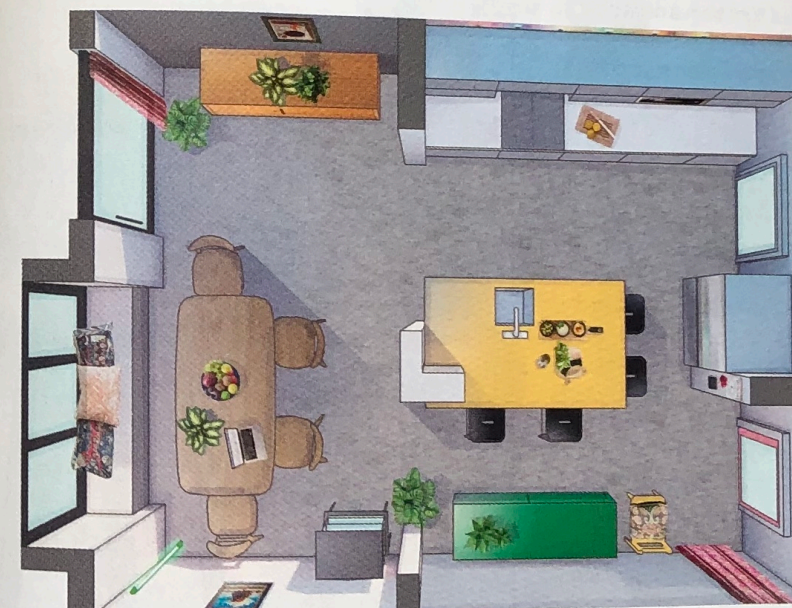

FEDERICA'S TIPS

Creating space

- Think outside the box: there wasn't enough room for Simon and Emma's table and chairs in the extension, so we created a projecting bay window, which provided space for seating.
- Consider how you use the house and plan accordingly. We converted a small, inner rear reception into a utility room, which is far more useful.
- Experiment with bold paint colours on walls – you can always change it!

BEFORE



DINING AREA
A wood dining table and chairs match the striking Tom Raffield oak light fitting

HOT TAP
The Minerva boiling water tap by Franke saves essential worktop space, as the couple no longer need a kettle

FLOORING

Grey Marmoleum provides a contrast to the brilliant yellow Corian worktop. 'We chose Marmoleum because it's made from natural raw materials, is sustainable and long-lasting,' says Emma

'That extra four square metres may not sound a lot, but it's made such a difference to how we live. Now we have a dining table that can seat six people easily'

original kitchen extension and then completely rebuilt it to span the width of the house at the back, effectively squaring off the projection. This meant we gained an extra four square metres, which, although it might not sound much, made a huge difference to us. It means we now have enough space in the new kitchen to have a full-size table where we can comfortably seat six – especially as Federica designed a bay window with bifold windows that include a space-saving built-in bench. This doubles as part of the seating for our new dining table, so we only need a single row of chairs.

What happened next?

The original kitchen – the part that hadn't been demolished – was gutted, rewired and partly replastered. Fortunately, the replumbing was fairly minimal because the new sink and dishwasher are in the same positions as the old ones. But we did have to take the drains through to the new utility room, which had been created from part of the old dining room. A small RSJ (rolled-steel joist) was put in

above the new bifold windows and door, and a new suspended timber floor, with insulation between the joists to reduce heat loss, replaced the old floor. We laid Marmoleum above it, replacing the existing laminate flooring. The building work took four months.

Your favourite finishing touches?

It has to be the Imperial Yellow Corian for the island worktop, which has become the focus of the room. I love a big, vibrant splash of colour, but just before buying it I lost my nerve and chose wooden worktops instead. I still have them – they've just not been fitted, as I decided I *did* want the yellow Corian after all! We used white Corian for the run of units along the wall so as not to overwhelm the space. The cabinetry is from John Lewis & Partners, and I installed it in exactly the same place as the previous cabinetry had been to take advantage of the existing plumbing. I love spending time in here now, sitting in the bay window with a cup of coffee and looking out onto our tiny courtyard garden.